



OPAL
BROCHURE

BALTHAZAR

BALTHAZAR



BALTHAZAR
YACHTING



OPAL

The Opal brings a rare combination of space and comfort that sets it apart from other yachts in its class. Designed with both relaxation and entertainment in mind, this yacht is perfect for intimate gatherings, family outings, or romantic escapes. Outside, the expansive flybridge provides a generous amount of space, ideal for lounging, socializing, or simply taking in the stunning ocean views. Whether you're looking to enjoy a relaxed afternoon under the sun or sip cocktails as the sun sets, the exterior layout offers plenty of room for everyone to spread out and enjoy the moment.

Step inside, and you'll find a thoughtfully designed interior that feels both cozy and spacious. The open-plan saloon and galley make it easy to entertain, while the three guest cabins, including a luxurious master suite, offer a retreat-like atmosphere after a day on the water. The yacht's layout ensures that you and your guests never feel confined, with plenty of room to move around and enjoy a seamless indoor-outdoor experience.

What makes the Opal truly special is its ability to adapt to your needs—whether it's an adventurous day of cruising or a quiet, private getaway. With its sleek design and ample space, it offers the perfect blend of style, performance, and comfort for those who appreciate a yacht that delivers more than just a day on the water—it offers an unforgettable experience.

At Glance



Build:
Azimut Yachts



Length:
43 ft (13.35m)

CAPACITY & SUITES



Guests:
12



No. of cabins:
3

KEY FEATURES

- Expansive Sun Deck
- Luxurious Italian Design
- Wide range of adventure and sports activities
- Wellness experiences
- Zero-speed stabilizers to reduce rolling motion while at anchor
- Swimming platform



BALTHAZAR



Upper Deck





Aft Deck



BALTHAZAR

BALTHAZAR



Main Lounge



BALTHAZAR



BALTHAZAR
YACHTING

Kitchen



VIP Suite

BALTHAZAR



BALTHAZAR

Twin Room



BALTHAZAR
YACHTING

Specifications



Build:
Azimut Yachts



Length
43 ft (13.35m)



Beam
4.40m



Draft
1.2m



Gross Tonnage
17,8 tons



Cruising Speed
18 Knots



Maximum Speed
23 Knots



Fuel Consumption
Cruising
180 L per hour



Engines
3 x 355 hp
Cummin QSB6.7

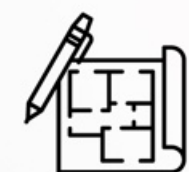

Interior Design
Azimut



Guests
12



Sleeps
8



Cabin Types
1 x Master Suite, 1x Single
1 x Twin Room



Crew
3





BALTHAZAR
YACHTING

Balthazar Yachting - Global Headquarters

Iris Bay Tower, Business Bay, Dubai, UAE

+971 4 608 6008 | dubai@balthazaryachting.com

www.balthazaryachting.com